

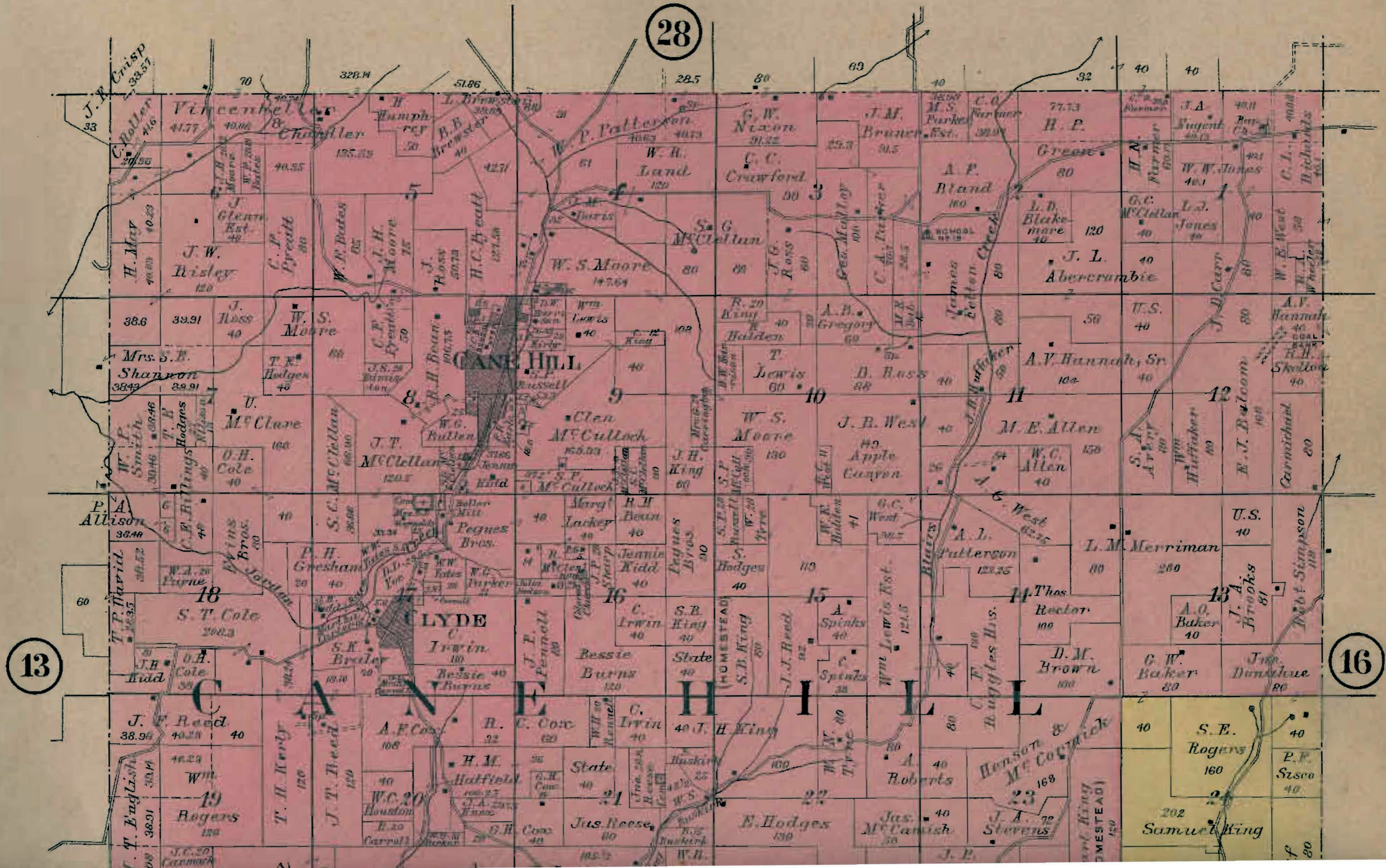

# TOWNSHIP 14 NORTH. RANGE 32 WEST.

Scale 2 Inches to the Mile.

of the 5<sup>th</sup> Principal Meridian.



13

16

8

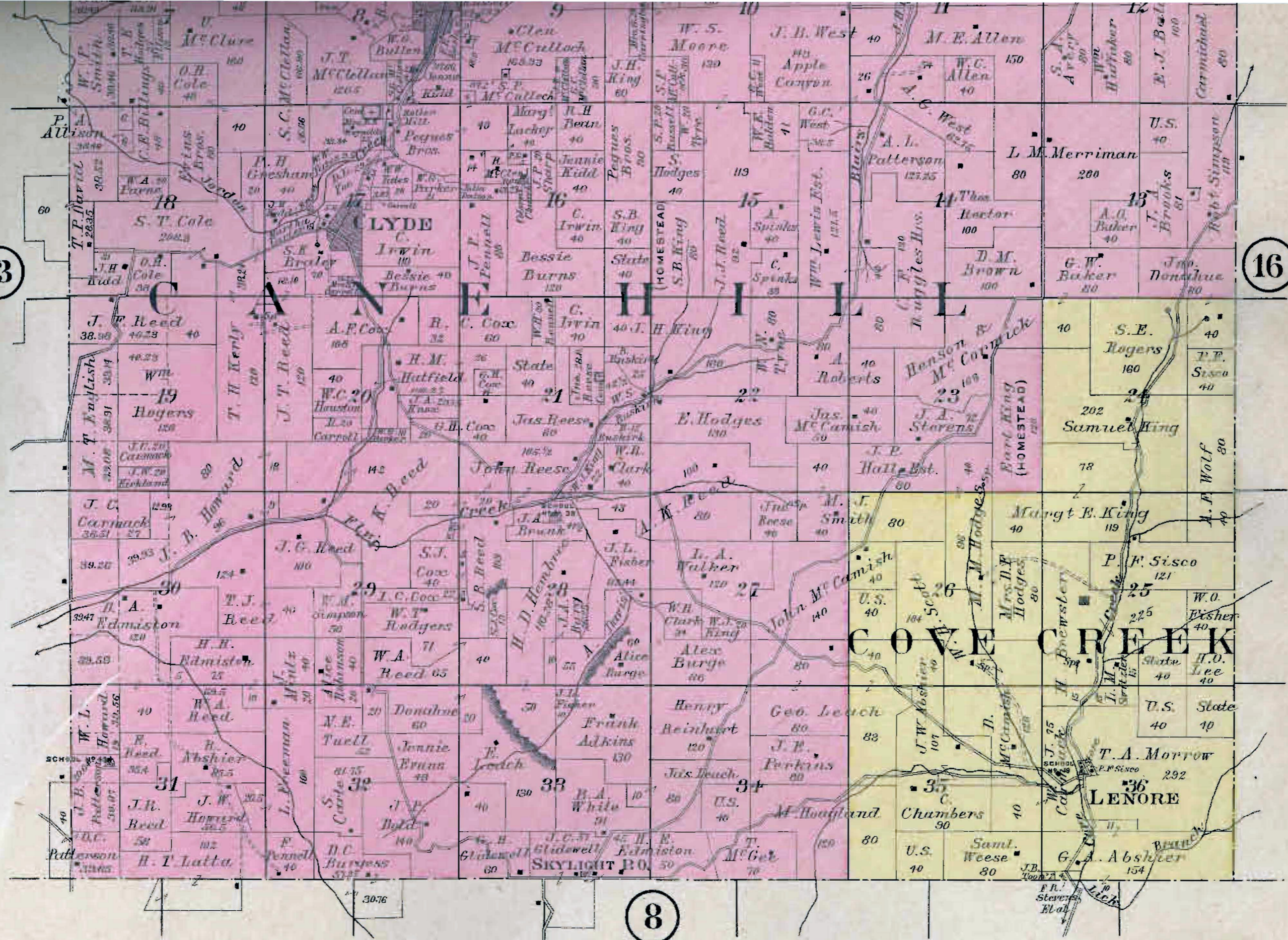

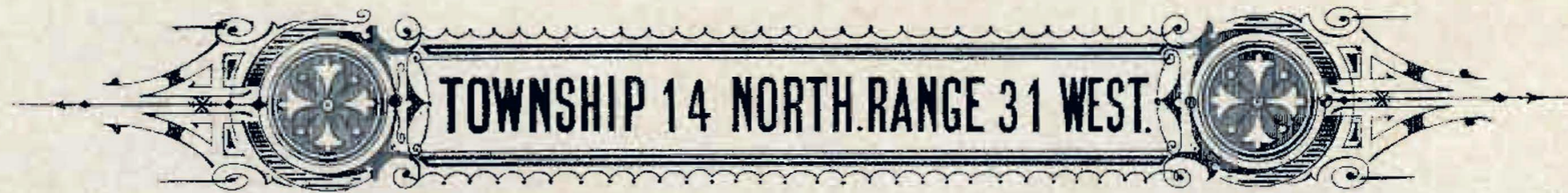

**TOWNSHIP 14 NORTH. RANGE 31 WEST.**

Scale 2 Inches to the Mile.

of the 5th Principal Meridian.

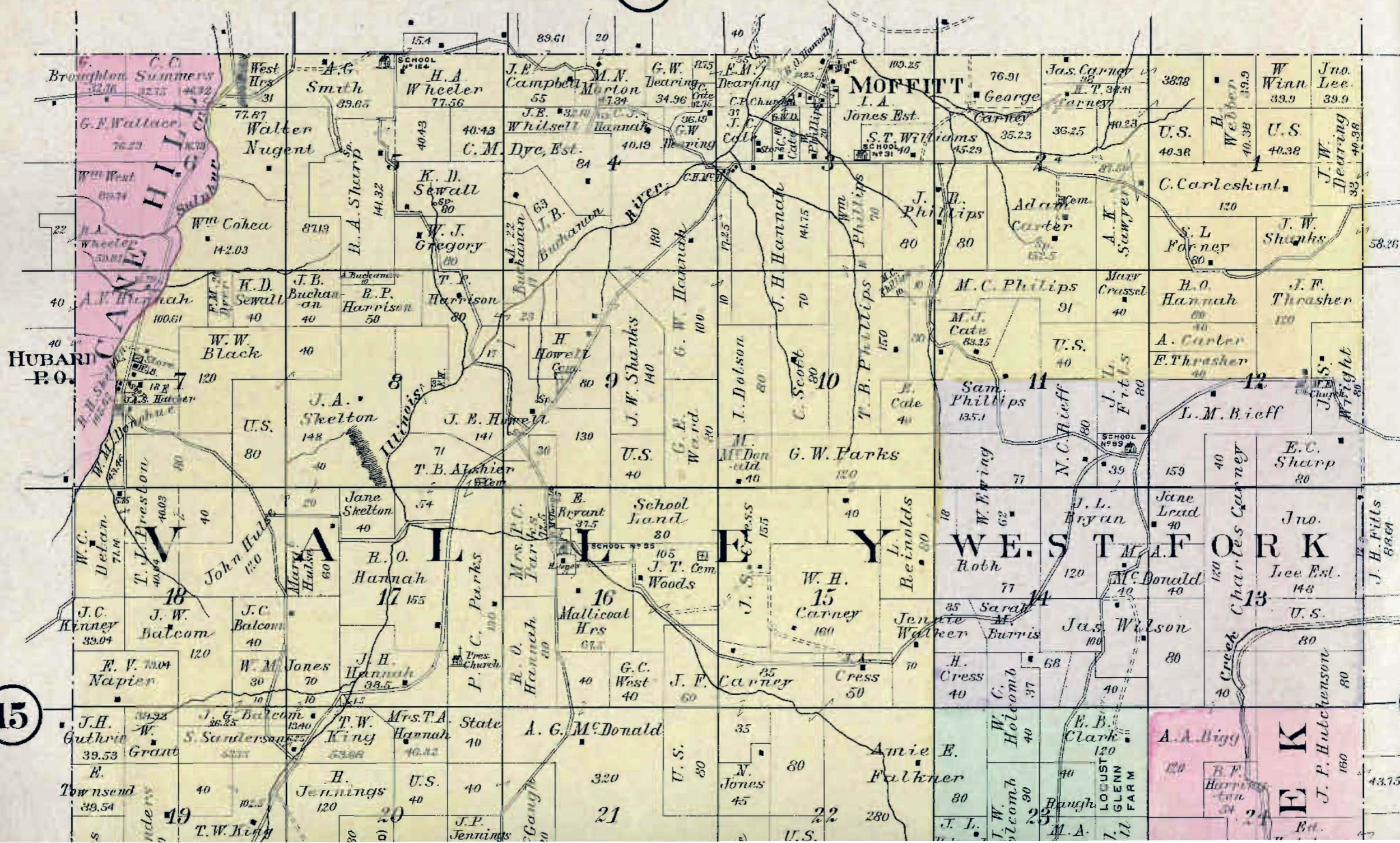
29



15

18

# CLYDE

ON SECTION 17 TWP. 14, R. 31  
Scale 300 feet to 1 inch

# MOFFITT

ON SECTION 3, T.P. 14, R. 31  
Scale 300 Feet

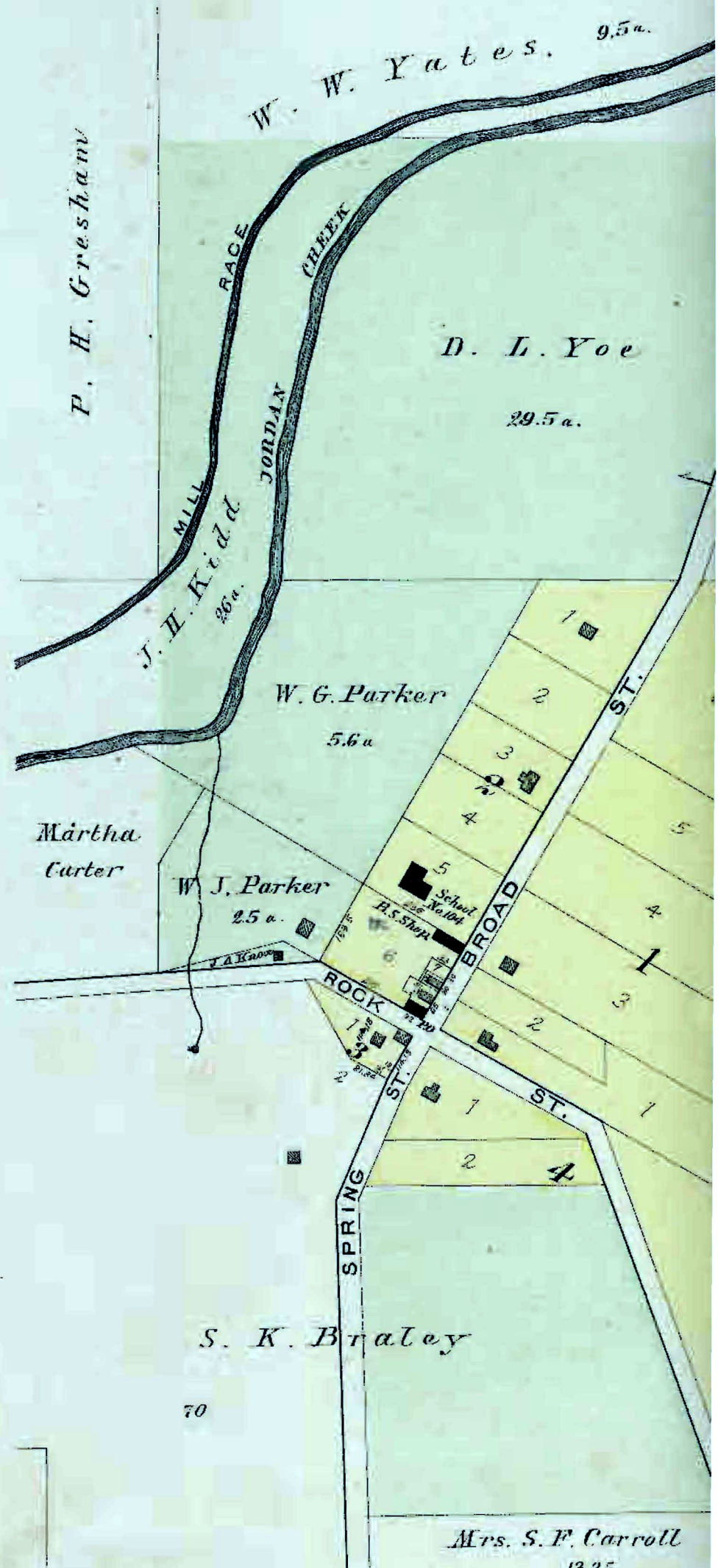
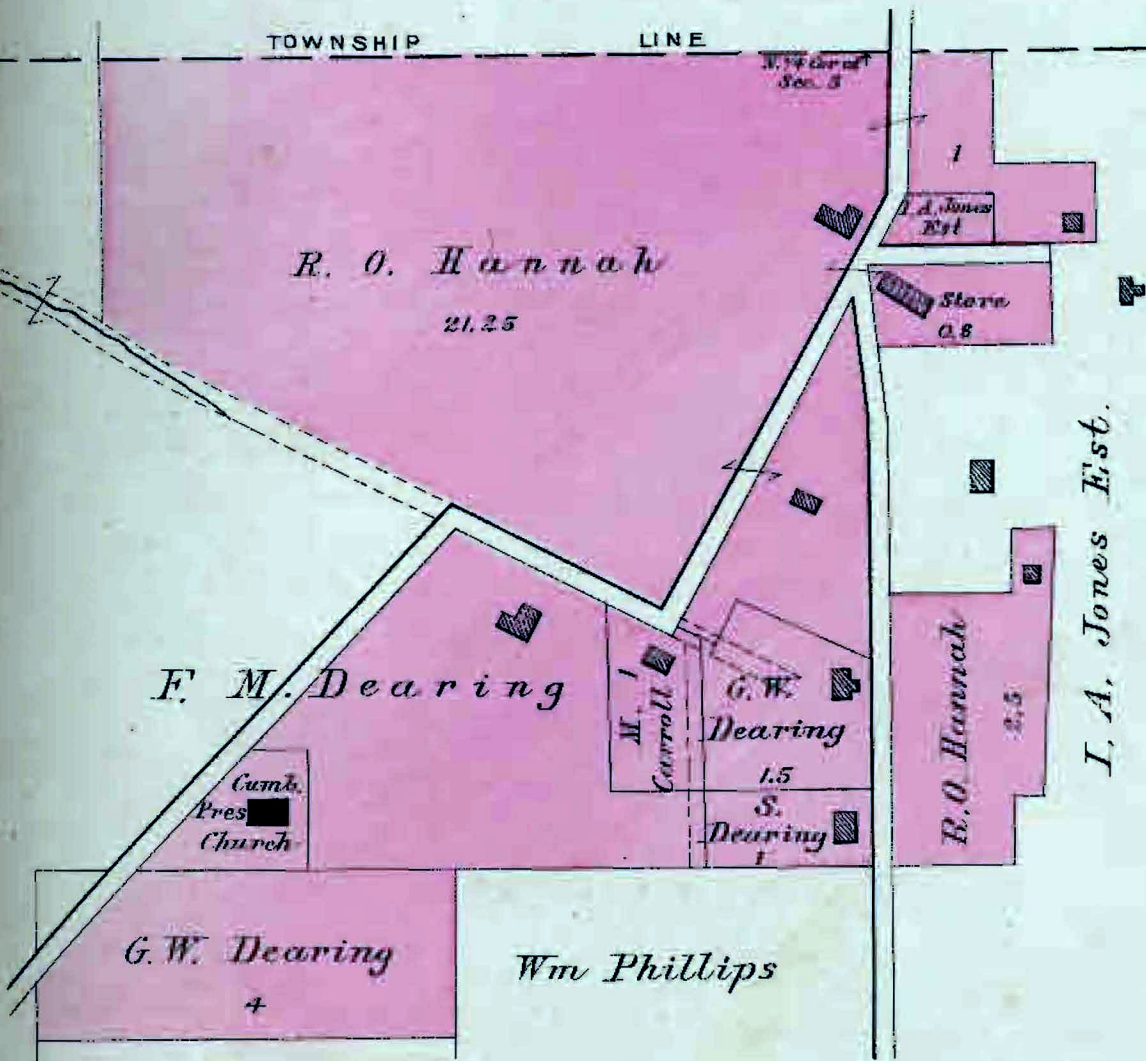

# CLYDE

ON SECTION 17 TWP. 14, RANGE 32

Scale 300 feet to 1 inch.

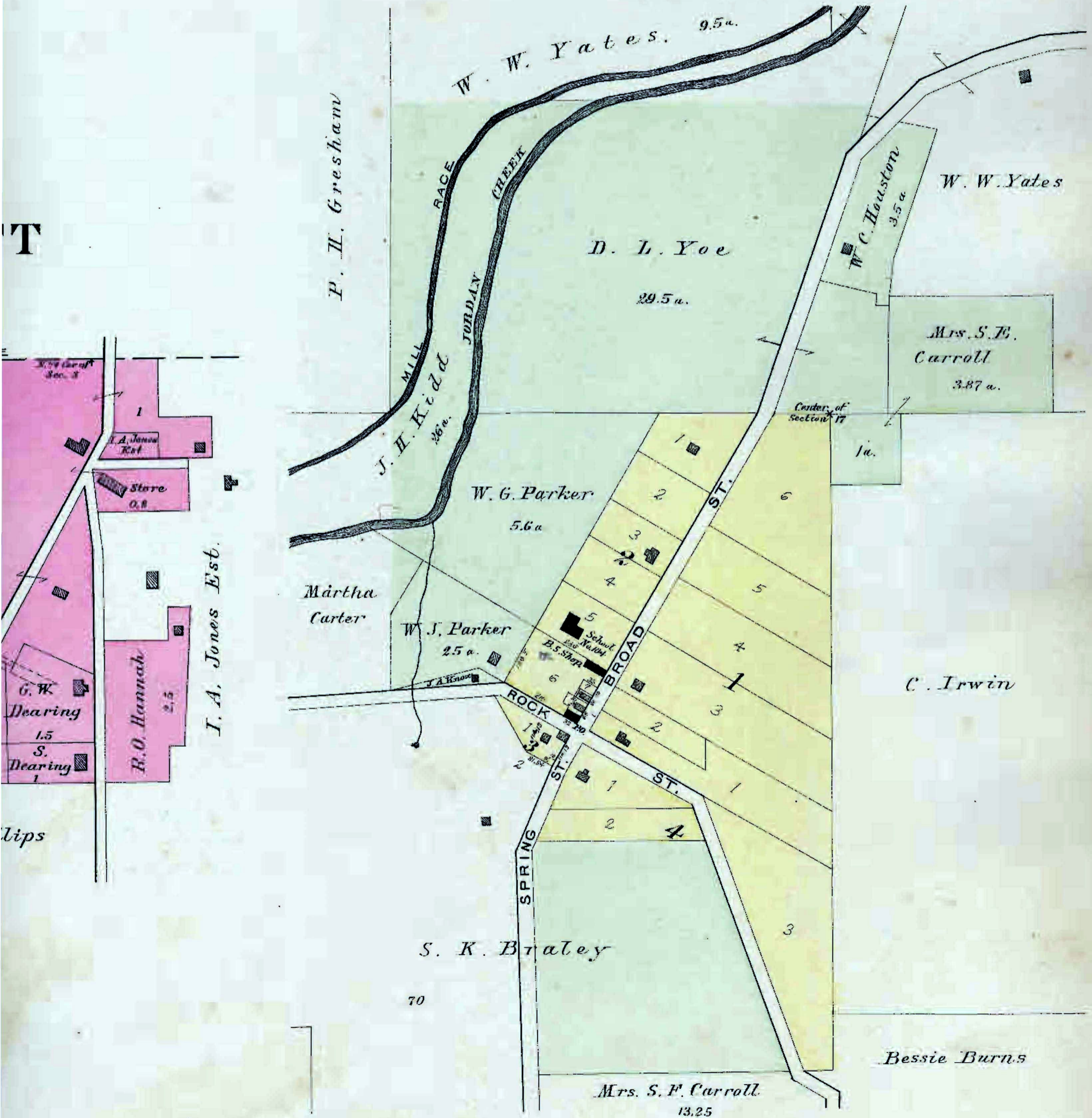

T

lips

32

29

15

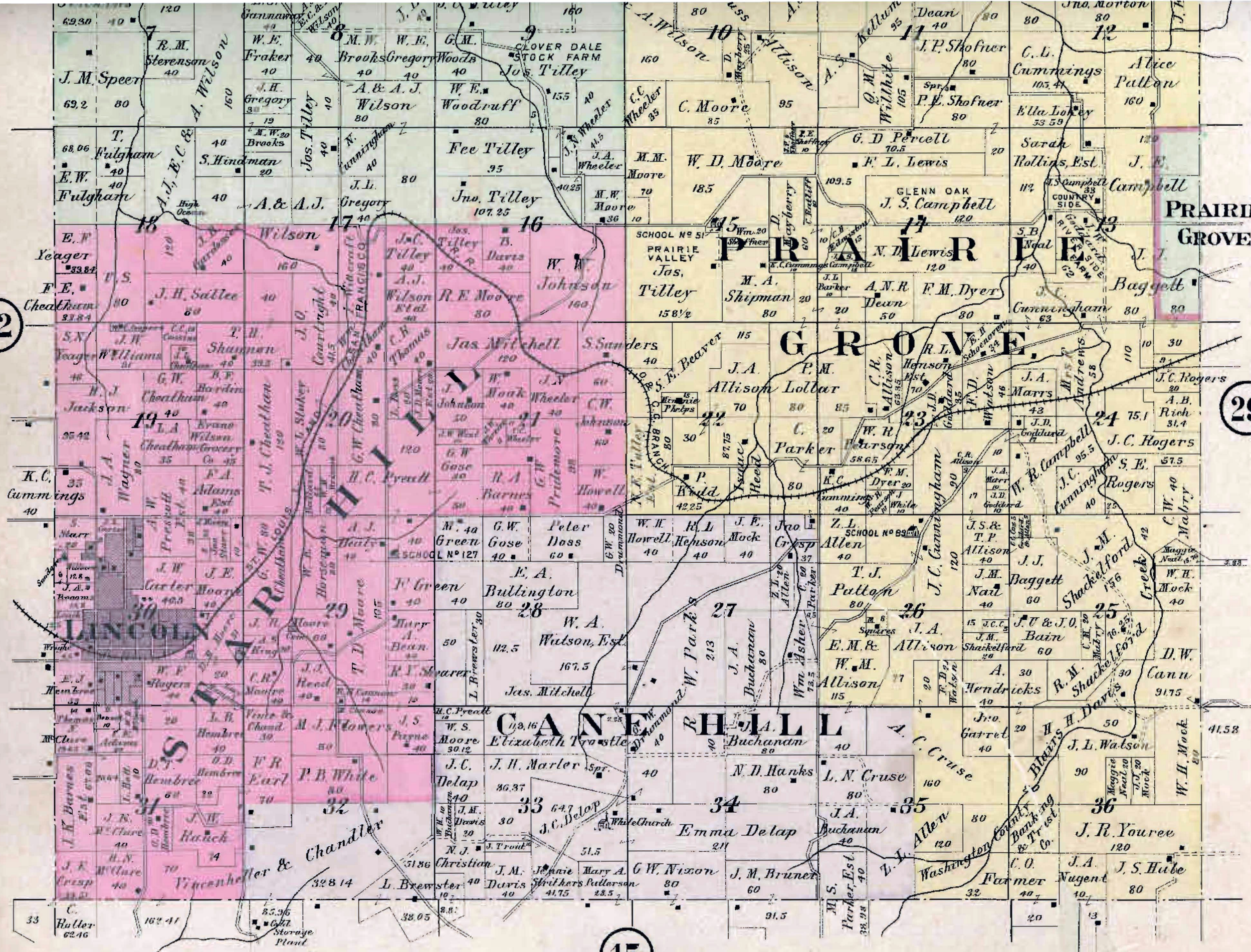

PRAIRIE GROVE

GROVE

LANCOLN

FRANKLIN

CANE

RHALL

Vincenholer & Chandler

Washington County Bank & Trust Co.

Elizabeth Trust

Blair's H. Davis

Shackelford

Shackelford

Shackelford

Shackelford

Shackelford

Shackelford

Shackelford

Shackelford

Shackelford

Shackelford

Shackelford

Shackelford

Shackelford

Shackelford

Shackelford

Shackelford

Shackelford

Shackelford